

T-Joints

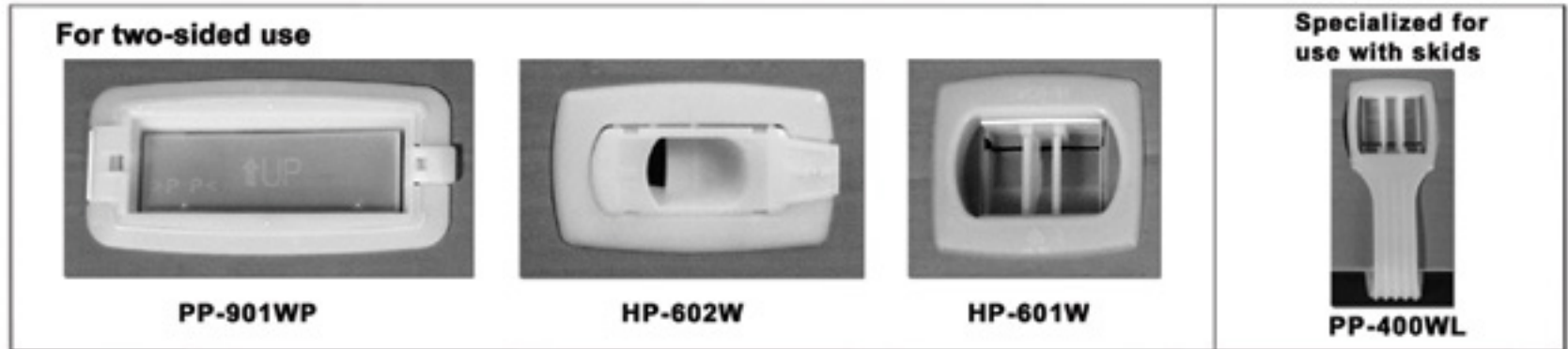

Specifications

Joint

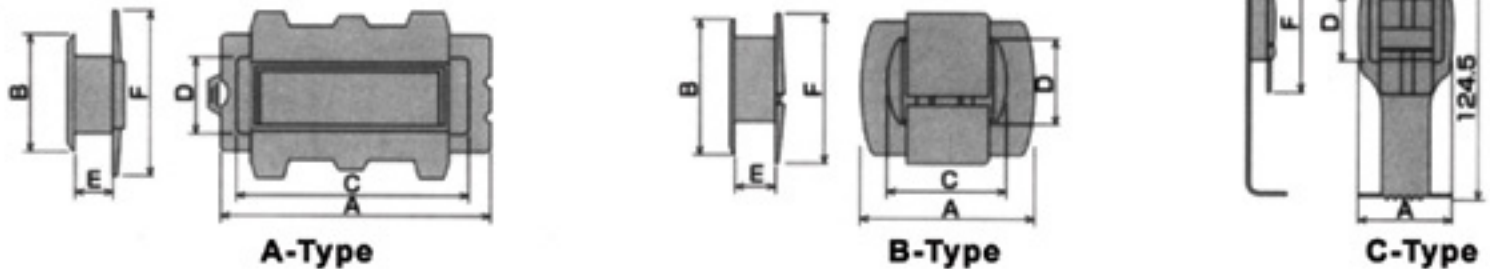

| Item | Kind | Joints | | | | |
|---------------------------|----------|--|---------|---------------------------------|------------|----------|
| | | A | | B | | C |
| Type Article | | PP-901WP | HP-602W | HP-601W | HP-601W | PP-400WL |
| Suitable corrugated | | Two-sided corrugated | | corrugated (3-layer corrugated) | corrugated | |
| Material | | Polypropylene (moisture-resistant, impact-resistant) | | | | |
| Distorted dimensions (mm) | | 13.4X104 | 16X60 | 15.5X59.5 | 25X60 | 8.5X43 |
| Acceptable Pressure | Material | | | AB+AB | AAA+AAA | AB+wood |
| | K340 | - | - | - | 66 | - |
| | K280 | 65 | 59 | 50 | - | 80 |
| | K220 | 64 | 46 | 48 | - | 74 |
| | K200 | 63 | 43 | 45 | - | 68 |
| External Dimensions | A | 121 | 77 | 72 | 72 | 47.5 |
| | B | 62 | 48 | 62 | 62 | - |
| | C | 104 | 59 | 60 | 60 | 40 |
| | D | 42 | 31 | 38 | 38 | 36.5 |
| | E | 15 | 16 | 15.5 | 25 | 9.5 |
| | F | 69.5 | 57.5 | 69 | 76 | 67 |

NOTES: (1) Numerical values of acceptable pressure with respect to cardboard show breaking strength of cardboard per joint (side 5 mm). (2) In designing cartons, use 3-4 times these ratings for the sake of safety.

* With reinforcing liner pasted in (0.7t kraft liner)

Acceptable Pressure

This number represents the maximum pressure 1 (one) fastener can withstand.

We recommend you plan your carton design using 3-4 times greater strength than the pressure numbers given above.

Measurements for installation

Main points of package design

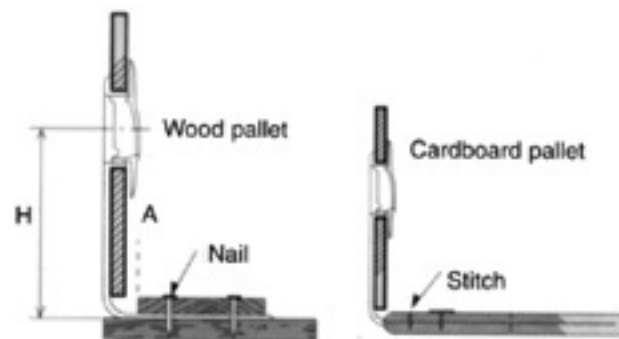
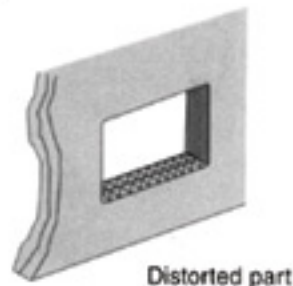
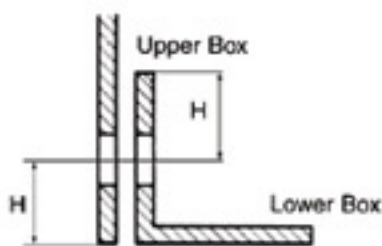

1. It is advisable to have a minimum of 60 mm from the center of the hole to the edge of the box.

2. The distorted part of the carton box lining should be in an upright position.

3. If the device is attached to a wooden pallet, be sure to position as shown above. (A and H should be 91 mm in length.)

Hole Types

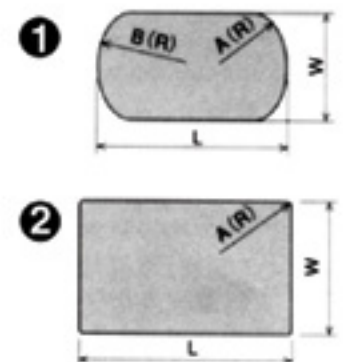

| Kind | Article | Type of hole | L X W | A | B |
|----------|----------|--------------|----------|----|----|
| T Joints | PP-901WP | 2 | 107 X 44 | 5 | - |
| | HP-602W | 1 | 62 X 31 | 9 | 25 |
| | HP-601W | 1 | 62 X 40 | 10 | 32 |
| | PP-400WL | 1 | 46 X 39 | 3 | 80 |

TO REQUEST A SAMPLE OR TO PLACE AN ORDER PLEASE CALL (201) 343-3330

T-Joints are easy to transport and easy to use

■ Features

- 1-piece joint provides two functions with just one joint.
- Ideal for 3-layer corrugated (2A, 3A).

■ Applications

- Separate packaging for various kinds of large or heavy goods, and large-sized assembled parts.
 1. Computers, faxes, and other office machines; home electrical appliances.
 2. Knock-down boxes for automobile parts.
 3. One-weight assembled boxes for various kinds of parts and products.
 4. Recyclable assembled boxes for various kinds of parts.



908
Oval Hand Clip

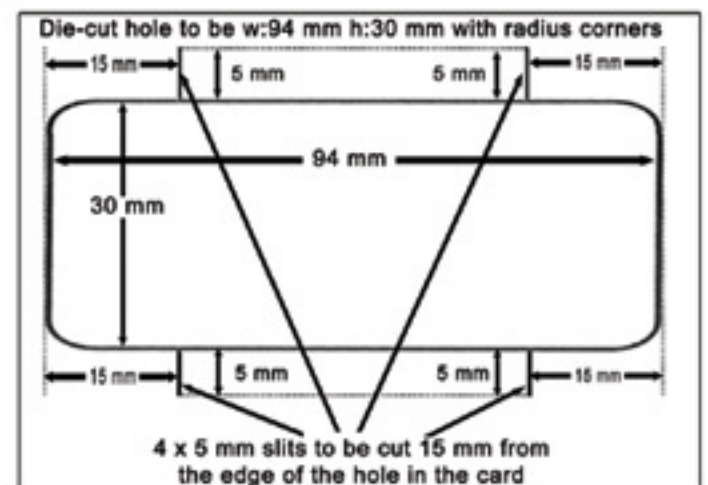

■ Methods of Packing and Repacking

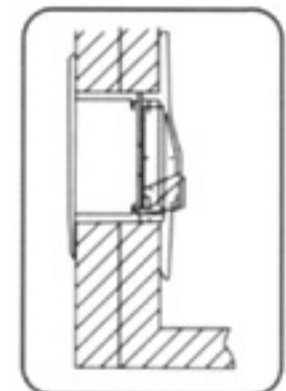
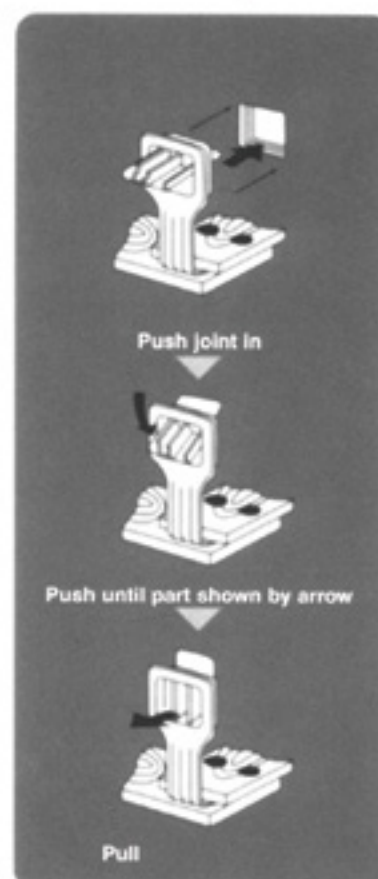
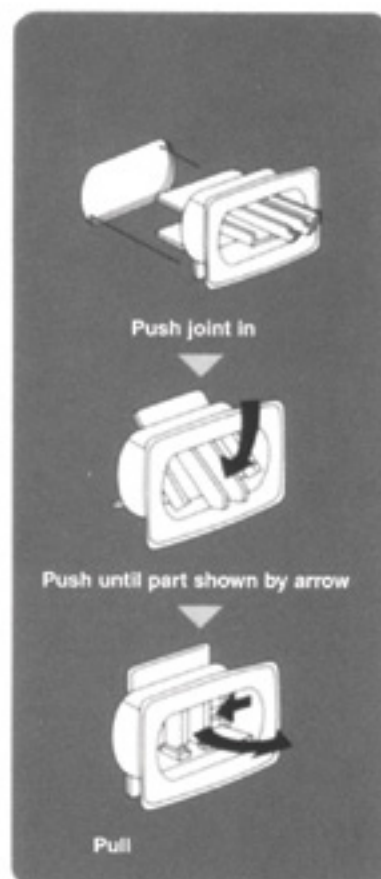
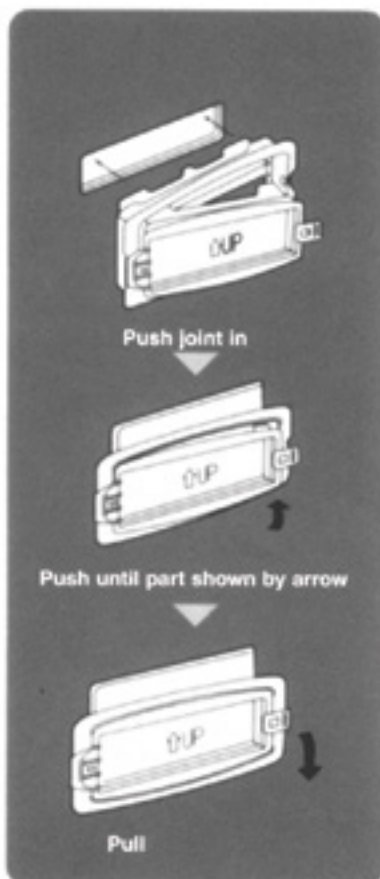

**TO REQUEST A
 SAMPLE OR TO
 PLACE AN ORDER
 PLEASE CALL
 (201) 343-3330**

■ Environmentally Sound

T-JOINTS

The joints are designed to fit with precision devices and machinery, which are multifunctional and large-scale, and emphasis was put on ease of carrying and dust-proofing.

EASY TO USE PACKING CLIPS

The packing clips are easy to secure and release, and do not cause damage during repacking, like tapes and staples.

RECYCLING

T-Joints are designed to endure multiple use, with reinforced bending points and other durability features supported by carefully selected materials. Because boxes are undamaged when opened, they can be used again and again. Efficient utilization of resources means reduced waste materials, and a real contribution to resolving environmental problems.